

Guida alle referenze Guide to references

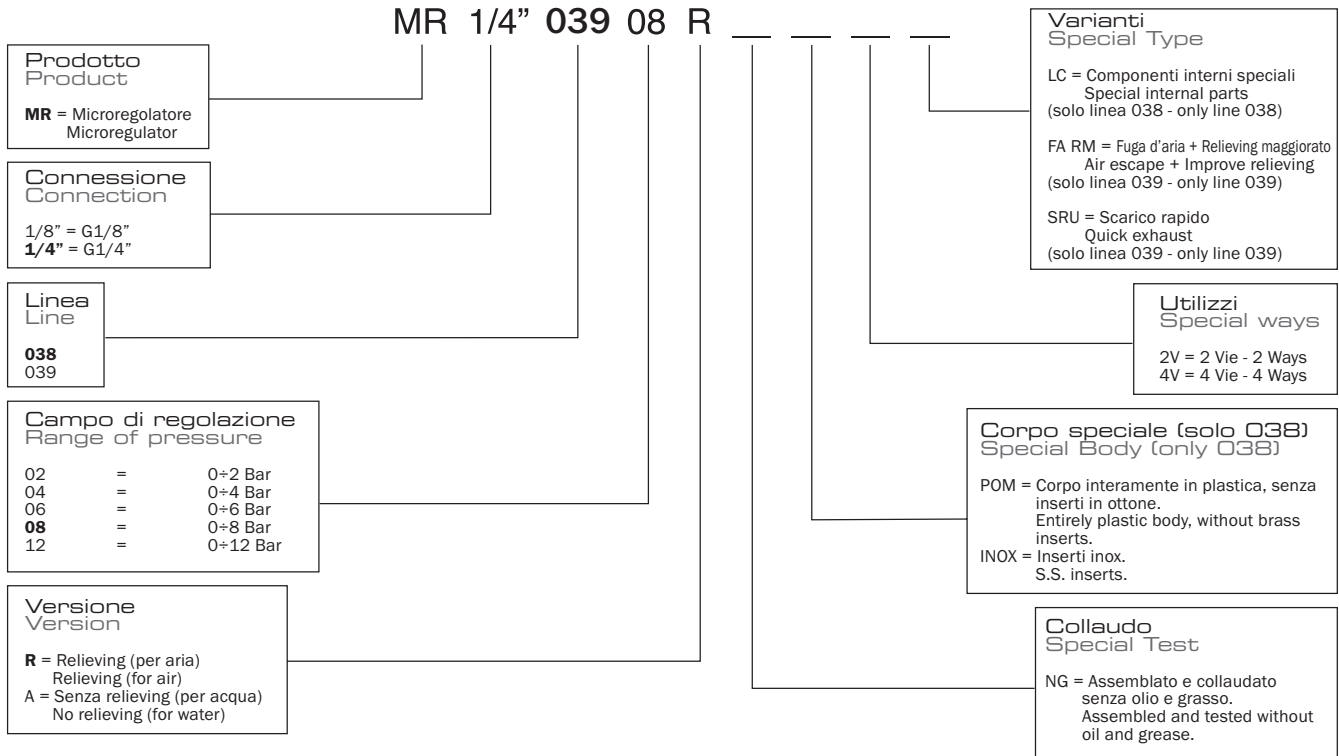

Microregolatore "MR 039" Microregulator "MR 039"

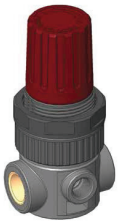

CODICE-CODE	REF.
039.00.00001	MR 1/8" 039 02 R
039.00.00002	MR 1/8" 039 04 R
→ 039.00.00003	MR 1/8" 039 08 R
039.00.00004	MR 1/8" 039 12 R
039.00.00201	MR 1/8" 039 02 A
039.00.00202	MR 1/8" 039 04 A
039.00.00203	MR 1/8" 039 08 A
039.00.00204	MR 1/8" 039 12 A
039.00.00401	MR 1/4" 039 02 R
039.00.00402	MR 1/4" 039 04 R
→ 039.00.00403	MR 1/4" 039 08 R
039.00.00404	MR 1/4" 039 12 R
039.00.00601	MR 1/4" 039 02 A
039.00.00602	MR 1/4" 039 04 A
039.00.00603	MR 1/4" 039 08 A
039.00.00604	MR 1/4" 039 12 A

Microregolatore speciale "LC" Special Microregulator "LC"

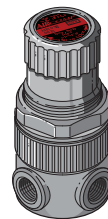

2 Vie - 2 Ways

CODICE-CODE	REF.
038.00.00129	MR 1/8" 038 NG 02 A 2V POM LC
038.00.00130	MR 1/8" 038 NG 04 A 2V POM LC
038.00.00092	MR 1/8" 038 NG 08 A 2V POM LC
038.00.00131	MR 1/8" 038 NG 12 A 2V POM LC

4 Vie - 4 Ways

038.00.00126	MR 1/8" 038 NG 02 A 4V POM LC
038.00.00127	MR 1/8" 038 NG 04 A 4V POM LC
038.00.00120	MR 1/8" 038 NG 08 A 4V POM LC
038.00.00128	MR 1/8" 038 NG 12 A 4V POM LC

Microregolatore "MR 039 FA-RM" Microregulator "MR 039 FA-RM"

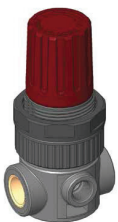

CODICE-CODE	REF.
039.00.00701	MR 1/8" 039 02 R FA-RM
039.00.00702	MR 1/8" 039 04 R FA-RM
→ 039.00.00703	MR 1/8" 039 08 R FA-RM
039.00.00704	MR 1/8" 039 12 R FA-RM
039.00.00801	MR 1/4" 039 02 R FA-RM
039.00.00802	MR 1/4" 039 04 R FA-RM
→ 039.00.00803	MR 1/4" 039 08 R FA-RM
039.00.00804	MR 1/4" 039 12 R FA-RM

→ = Standard version

Microregolatore "non manomettabile"
Microregulator "not adjustable"

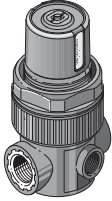

Microregolatore con pressione impostata a richiesta, con pomello bloccato antimanomissione.
Microregulators with pre-set pressure and fixed knob not adjustable.

Microregolatore "039 INOX"
Microregulator "039 INOX"



CODICE-CODE	REF.
039.00.00027	MR 1/8" 039 02A INOX 2V FG
039.00.00028	MR 1/8" 039 04A INOX 2V FG
039.00.00029	MR 1/8" 039 08A INOX 2V FG
039.00.00030	MR 1/8" 039 12A INOX 2V FG

Microregolatore "MR 039 SRU" scarico rapido
Microregulator "MR 039 SRU" quick exhaust

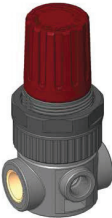

CODICE-CODE	REF.
039.00.00022	MR 1/8" 039 02 R SRU
039.00.00023	MR 1/8" 039 04 R SRU
→ 039.00.00024	MR 1/8" 039 08 R SRU
039.00.00025	MR 1/8" 039 12 R SRU
039.00.00441	MR 1/4" 039 02 R SRU
039.00.00442	MR 1/4" 039 04 R SRU
→ 039.00.00443	MR 1/4" 039 08 R SRU
039.00.00444	MR 1/4" 039 12 R SRU

Microregolatore "039 POM 1/4"
Microregulator "039 POM 1/4"



CODICE-CODE	REF.
039.00.000250	MR 1/4" 039 02A 2V POM FG
039.00.000251	MR 1/4" 039 04A 2V POM FG
039.00.000252	MR 1/4" 039 08A 2V POM FG
039.00.000253	MR 1/4" 039 12A 2V POM FG
039.00.000246	MR 1/4" 039 02A 4V POM FG
039.00.000247	MR 1/4" 039 04A 4V POM FG
039.00.000248	MR 1/4" 039 08A 4V POM FG
039.00.000249	MR 1/4" 039 12A 4V POM FG

Accessori e ricambi Spare parts

Gruppo membrana completo
Diaphragm complete

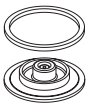

CODICE-CODE	LINE	VERSION
C38.00.00087	038 LC	NON RELIEVING
C39.00.00074	039	RELIEVING
C39.00.00075	039	NON RELIEVING
C39.00.00076	039	FA-RM
C39.00.00077	039 INOX	NON RELIEVING
C39.00.00086	039 POM	NON RELIEVING



Staffa fissaggio a parete
Bracket

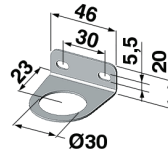

CODICE-CODE
C38.00.00069

Molla regolazione
Regulation spring



CODICE-CODE	LINE	SET REGULATION
A38.00.00133	039	0÷1 Bar
A38.00.00132	039	0÷2 Bar
A38.00.00131	039	0÷4 Bar
A38.00.00130	039	0÷8 Bar
A38.00.00129	039	0÷10 Bar
A38.00.00128	039	0÷12 Bar



Grano G1/8"
Plug G1/8"



CODICE-CODE	LINE
B38.00.00018	038 - 039

Manometro
Gauge

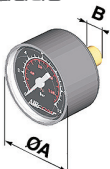

CODICE-CODE	Bar	Psi	A	B	CH.
A38.00.00026	0÷12	0÷175	40	G1/8"	14
A38.00.00055	0÷6	0÷85	40	G1/8"	12
A38.00.00114	0÷2,5	0÷36	40	G1/8"	12

→ = Standard version